

CABLE TIE FIXINGS

Accessories

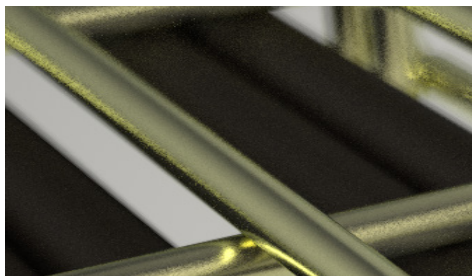

Remora offers various solutions to securing and anchoring cables bundled by cable ties. 4-way adhesive bases are predominantly used for lighter loads, cable tie saddles for the more bulky or heavier cables and masonry mounts for fixing without adhesive or screws. All readily available from stock.



Cable Tie Saddles

Cable Tie Saddles designed to provide a secure fixing for cables. These can be simply installed with a screw or bolt. Secure using M4 or M6 fixing.

Material: Nylon 66

Colour: Black

Operating Temperature: -40°C to 85°C

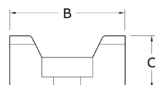
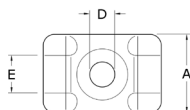

Code	Colour	(A)	(B)	(C)	Fixing Hole (D)	Max Tie Width (E)	Pack QTY
NCCB5	Black	13.0	18.0	8.2	4.0	5.0	100
NCCB11	Black	16.0	22.0	9.5	5.0	9.5	100
NCCB18	Black	18.5	40.0	16.5	6.0	12.7	100

Cable Tie 4-way Adhesive Base

Manufactured from Nylon 66 with an adhesive base. Two bases are assembled on a backing strip for easy removal. With high levels of instant tack and shear adhesion these bases take cable ties up to 10.2mm widths.

Material: Nylon 66

Operating Temperature: -40°C to 85°C

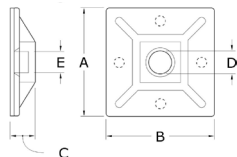

Code	Colour	(A)	(B)	(C)	Fixing Hole (D)	Max Tie Width (E)	Pack QTY
RNBB1	Black	19.5	19.5	3.9	5.0	4.6	100
RNBB2	Black	28.6	28.6	5.3	5.0	5.5	100
RNBB3	Black	38.5	38.5	7.6	5.0	10.2	100
RNB1	Natural	19.5	19.5	3.9	5.0	4.6	100
RNB2	Natural	28.6	28.6	5.3	5.0	5.5	100
RNB3	Natural	38.5	38.5	7.6	5.0	10.2	100

Nylon Tie Base Box Kit

Assorted range of Cable Tie Saddles and Adhesive Bases in Black and Natural, supplied in a Box Kit.

Material: Nylon 66

Colour: Black, Natural

Operating Temperature: -40°C to 85°C



Code	Description	Cable Tie Size Range
BK11	8 Compartment / Approx 180 Items	2.5 - 7.6