

# METALLIC CABLE GLANDS | Cable Glands

## GRIPLOC® STAINLESS STEEL CABLE GLANDS

### Stainless Steel GripLoc® Glands Metric

- Standard Metric range of Stainless Steel cable glands.
- GripLoc Seal® - Superior Ingress Protection, mechanical grip and cable retention.

**Standards:** EN 50262

**Protection:** IP69K / IP68 10 bar (150 PSI)

**Temperature Range:** -40°C to 100°C (static) (120° Instantaneous)

**Material (Gland):** 304 Stainless Steel <sup>1</sup>

**Material (Seal):** NBR Seal and EPDM O-Ring

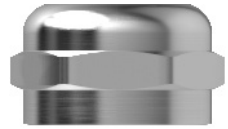
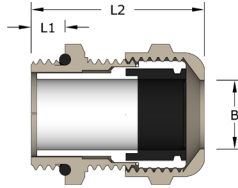

Multi-Hole Seals p.115 Locknuts Supplied Separately p.177

Code	Cable Range (B)		Entry Thread		Gland	
	Min	Max	Size	Length (L1)	Length (L2)	A/F
GripLoc-SS-M12	2.0	5.0	M12 x 1.5	6.5	25.5	14.0
GripLoc-SS-M16	5.0	10.0	M16 x 1.5	6.0	27.0	19.0
GripLoc-SS-M20	6.0	12.0	M20 x 1.5	6.0	29.0	22.0
GripLoc-SS-M20L	10.0	14.0	M20 x 1.5	6.0	30.0	24.0
GripLoc-SS-M25	13.0	18.0	M25 x 1.5	7.0	32.0	30.0
GripLoc-SS-M32	18.0	25.0	M32 x 1.5	8.0	39.0	40.0
GripLoc-SS-M40	22.0	32.0	M40 x 1.5	8.0	45.0	50.0
GripLoc-SS-M50	32.0	38.0	M50 x 1.5	9.0	46.0	57.0
GripLoc-SS-M63	37.0	44.0	M63 x 1.5	10.0	48.0	68.0

<sup>1</sup> 316 Stainless Steel available to order

- Long Thread available to order



Ident & Wiring Term  
Copper Lugs  
Heatshrink Repair  
Cable Joining  
Junction Boxes  
Flexible Conduit  
Cable Glands  
Gland Accs.  
Cable Cleats  
Earthing Lightning  
MCC Cable  
Cable Ties & Acc  
Tooling & Cable Prep  
Fixing & Security



Call the Remora sales team at 01226 352 000

Challenge us - We find a solution