

BARREL EARTH INSULATORS

Barrel Insulators and Assemblies

Remora Barrel Insulators are used as insulating supports for active conductors. They can also be used as a support for electrical devices as well as a spacing and/or stiffening element in an electrical system. Manufactured from tough Glass Reinforced Polyester (GRP) they provide excellent electrical insulation and high mechanical strength.

Temperature Max: 200°C (static)

Material: Glass Reinforced Polyester

Colour: Grey as standard, Red available to order

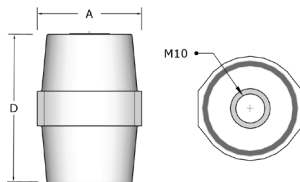

Code	Height (D)	A/F (A)	Insert Thread Size (C)	Insert Depth	Electrical Dielectric Strength	Tensile Strength	Torque Nm
EI	51	36.0	M10	14.5	10 KV/mm	3-5 Kgf/mm ²	>30
EI03	51	36.0	M10	14.5	10 KV/mm	3-5 Kgf/mm ²	>30



EI = Insulator only

EI03 = Insulator complete with 2 studs and 3 nuts

Brass Set Screws

Range of brass fixings including Brass Hex Set Screws, Brass Hex Nuts & Brass Plain Washers

Material: Brass

Standards: Set Screw DIN933

Hex Nut DIN934

Plain Washer DIN 125A

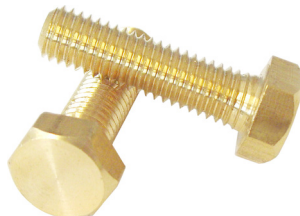

Code	Size	Pack QTY	Code	Size	Pack QTY	Code	Size	Pack QTY
BSS0616	M6 x 16	100	BSS0825	M8 x 25	100	BSS1025	M10 x 25	100
BSS0620	M6 x 20	100	BSS0835	M8 x 35	100	BSS1035	M10 x 35	100
BSS0625	M6 x 25	100	BSS0840	M8 x 40	100	BSS1040	M10 x 40	100
BSS0640	M6 x 40	100	BSS0850	M8 x 50	100	BSS1050	M10 x 50	100

Brass Hex Nuts

Code	Size	Pack QTY
BN06	M6 Hex Nut	100
BN08	M8 Hex Nut	100
BN10	M10 Hex Nut	100



Brass Plain Washers

Code	Size	Pack QTY
BW06	M6 Washer	100
BW08	M8 Washer	100
BW10	M10 Washer	100



Call the Remora sales team at **01226 352 000**

Challenge us - We find a solution