

SECTION CONTENTS | Ident & Terminals

CORD END & DUAL CORD END TERMINALS

Uninsulated Cord End (Bootlace) Terminals

Uninsulated cord end terminal for terminating cable ends before fitting into screw type termination blocks/connectors.



- Flared barrel for easy wire insertion.

Temperature Range: -40°C to 105°C

Material: Tin Plated Copper

Voltage: 600V

Standards: DIN 46288 Part 1

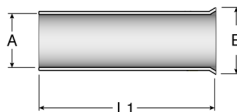

Code	Range mm ²	ID (A)	ID (B)	Pin (L1)	Pack QTY
UNCE0.5-6	0.50	1.0	1.7	6.0	100
UNCE0.75-10	0.75	1.2	1.9	10.0	100
UNCE1.0-10	1.0	1.4	2.2	10.0	100
UNCE1.5-10	1.5	1.7	2.5	10.0	100
UNCE2.5-12	2.5	2.3	3.3	12.0	100
UNCE4.0-12	4.0	2.8	3.9	12.0	100
UNCE6.0-15	6.0	3.5	4.7	15.0	100
UNCE10.0-18	10.0	4.5	5.8	18.0	100
UNCE25.0-15	25.0	7.5	9.1	15.0	100
UNCE35.0-18	35.0	8.3	10.2	18.0	100
UNCE50.0-32	50.0	10.3	11.5	32.0	100
UNCE70.0-32	70.0	14.8	15.8	32.0	100
UNCE95.0-32	95.0	14.8	17.3	32.0	100
UNCE120.0-32	120.0	16.7	20.2	32.0	100

Dual Cord End (Bootlace) Terminals

A complete range of dual entry cord end terminals. Designed to accommodate two cables terminating in the same sleeve.

- They are ideal for looping conductors.

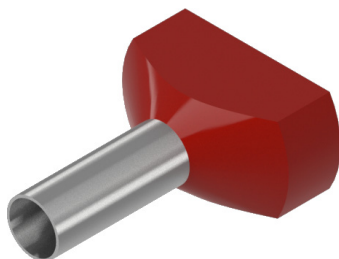

Temperature Range: -40°C to 105°C

Material: Tin Plated Copper / Nylon Insulation

Colour: Black, Blue, White, Grey, Yellow, Red

Voltage: 600V

Standards: DIN 46288 Part 4

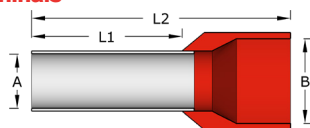

Code	Colour	Range mm ²	ID (A)	ID (B)	Pin (L1)	Length (L2)	Pack QTY
TWIN0.50	White	2x 0.50	1.5	4.9	8.0	15.0	100
TWIN0.75	Grey	2x 0.80	1.8	5.2	8.0	15.0	100
TWIN1.0	Red	2x 1.0	2.0	5.3	8.0	15.0	100
TWIN1.5	Black	2x 1.5	2.3	6.5	8.0	16.0	100
TWIN2.5	Blue	2x 2.5	2.9	8.0	10.0	18.5	100
TWIN4.0	Grey	2x 4.0	3.8	8.8	12.0	23.0	100
TWIN6.0	Yellow	2x 6.0	4.9	9.3	14.0	26.0	100
TWIN10.0	Red	2x 10.0	6.5	12.8	14.0	26.5	100
TWIN16.0	Blue	2x 16.0	8.3	18.5	14.0	30.5	100