

# Cable Glands | HAZARDOUS AREA CCG™ CABLE GLANDS

INDOOR/OUTDOOR - STEEL WIRE, BRAID and TAPE ARMOUR

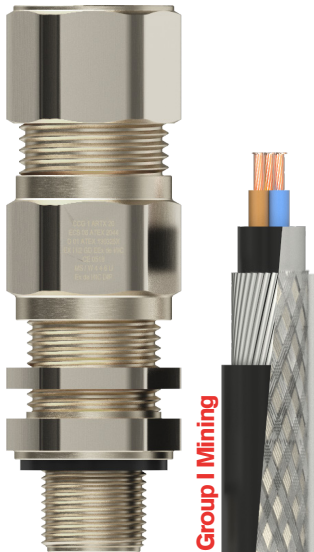

## CCG ARMORTEX™ Cable Gland

The Armortex Gland, designed for hazardous areas EExde Group I / IIC, incorporates the MAC (Multi-Armour Captive Cone), providing an armour clamp and earth bond with Steel Wire, Braid and Tape armoured cables.

- For Group I underground mines, Group II, III, Zone 1, 2, 21 and 22 hazardous areas.
- Freely rotating multi armour captive cone and inspectable cone ring provides an armour clamp and earth bond on braid, tape or steel wire armour.
- Armour clamp components can be inspected after installation
- Captive Cone and Ring enables use with Steel Wire, Braid and Tape.
- Extra long captive explosion proof seal ensures *Build In Safety™*.
- Gland can be used on Ex d enclosures greater than 2 litres in volume.
- Manufactured from high-quality brass (Marine Grade Electroless Nickel Plated™).
- Supplied complete with IP sealing washer.

### Equipment Protection Levels:

IECEx/INMETRO: Ex d I Mb/ IIC Gb, Ex e I Mb/IIC Gb, Ex nR IIC Gc, Ex ta IIC Da  
ATEX/UKEX: Ⓢ I M2, Ⓢ II 2/3G 1D, Ex db I Mb/ IIC Gb, Ex eb I Mb/IIC Gb, Ex nR IIC Gc, Ex ta IIC Da

### Conformance: Standard:

IEC/BS EN IEC/BS EN 62444  
IECEx IEC 60079 Part 0, 1, 7, 15, 31  
ATEX EN 60079 Part 0, 1, 7, 31  
EN 60079 Part 0, 15  
UKEX BS EN 60079 Part 0, 1, 7, 31  
BS EN 60079 Part 0, 15

### Certification:

CML 14CA364  
IECEx TSA 22.0011X  
CML 16ATEX1001X  
CML 16ATEX4002X  
CML 21UKEX1011X  
CML 21UKEX4006X  
DTS-01

### Deluge Protection:

Marine: ABS IEC/EN 60079 Part 0, 1, 7, 15, 31 and IEC 60529  
DNV IEC/EN 60079 Part 0, 1, 7, 15, 31 and IEC 60529



**Protection:** IP66 / IP68 (100m - Parallel) IEC 60529

**Temperature Range:** Standard -60°C to 95°C / Extreme -60°C to 160°C

**Material (Gland):** Brass / Marine Grade Electroless Nickel Plated™

**Material (Seal):** Standard Thermoset Elastomer or Extreme Temperature Seals

Code	Reference Size	Bedding OD (A)		Cable OD (B)		Gland Length (L2)	Armour Dia (F)		Thread Entry (C)	Length (L1)	A/F	A/C
		Min	Max	Min	Max		Min	Max				
052216A	00 - 16ss	3.0	8.0	8.0	13.5	88.0	0.20	1.25	M16 x 1.5	15.0	25.0	28.0
052200A	00 - 20ss	3.0	8.0	8.0	13.5	88.0	0.20	1.25	M20 x 1.5	15.0	25.0	28.0
0522-0A	0 - 20s	8.0	11.5	11.5	16.0	88.0	0.20	1.25	M20 x 1.5	15.0	25.0	28.0
052201A	1 - 20	11.5	14.0	12.5	19.0	93.0	0.20	1.25	M20 x 1.5	15.0	27.0	30.0
052202A	2 - 25	14.0	20.2	18.0	26.5	100.0	0.20	1.60	M25 x 1.5	15.0	40.0	45.0
052203A	3 - 32	20.0	26.5	23.0	33.0	110.0	0.20	2.00	M32 x 1.5	19.0	45.0	51.0
052204A	4 - 40	26.5	34.0	28.0	40.5	123.0	0.30	2.00	M40 x 1.5	21.0	55.0	62.0
052255A	5s - 50s	32.5	38.0	35.2	46.0	123.0	0.40	2.50	M50 x 1.5	21.0	70.0	79.0
052205A	5 - 50	38.0	44.5	44.4	52.0	123.0	0.40	2.50	M50 x 1.5	21.0	70.0	79.0
052266A	6s - 63s	44.5	50.0	45.5	60.0	160.0	0.40	2.50	M63 x 1.5	21.0	85.0	96.0
052206A	6 - 63	50.0	56.0	54.6	67.0	160.0	0.40	2.50	M63 x 1.5	21.0	85.0	96.0
052207A	7 - 75	56.0	65.0	59.0	78.0	170.0	0.40	3.15	M75 x 1.5	30.0	96.0	108.0

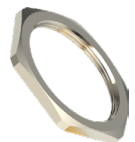
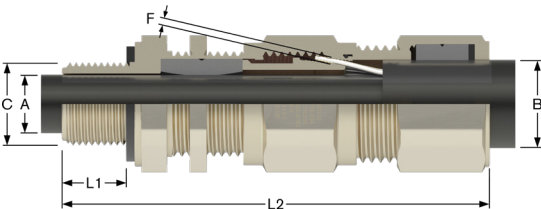

Locknuts Supplied Separately p.177

CCG® brand cable glands are offered for sale exclusively in the United Kingdom by Remora Electrical Limited.

All dimensions in mm except where stated