

FLEXIBLE GALVANISED STEEL CONDUIT

Steel

SoliFlex

Galvanised Steel Conduit

Galvanised Steel, helically wound conduit for extreme flexibility. Ideal for general use where mechanical protection is required, commonly used in general factory wiring and connections to machinery. Metallic conduit systems offer higher compression strength than non-metallic. The flexible body facilitates easy installation with cornering and elbow options. Metallic conduit systems have superior protection and protection from electromagnetic interference and good mechanical abrasion resistance. Crush resistance of 1250N.

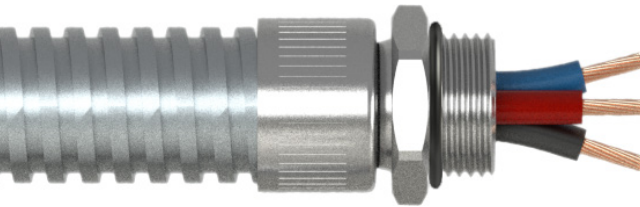

Galvanised Steel

- Extreme Flexibility
- High mechanical strength
- IP rating: IP40
- Temperature range: -30°C to +300°C
- Nickel plated Heavy Duty brass fittings
- Offers high abrasion resistance

Galvanised Steel Conduit

• Square locked galvanised steel conduit, good mechanical stability with extreme flexibility.

Temperature Range: -30°C to 300°C

Crush Resistance: 1250N

IP Rating: IP40

Material: Galvanised Steel to DIN 53210

Standards: BS EN 61386.1 / 2005



Code	Conduit Size	Conduit ID	Conduit OD	Coil Lengths (m)
GALV-M16/50	16	13.0	16.0	50
GALV-M20/25	20	17.0	21.0	25
GALV-M20/50	20	17.0	21.0	50
GALV-M25/25	25	22.0	27.0	25
GALV-M25/50	25	22.0	27.0	50
GALV-M32/25	32	28.0	32.0	25