

# Cable Glands | METALLIC CABLE GLANDS

## BRASS CABLE GLANDS

Ident & Wiring Term  
Copper Lugs  
Heatshrink Repair  
Cable Joining  
Junction Boxes  
Flexible Conduit  
Cable Glands  
Gland Accs.  
Cable Cleats  
Earthing Lightning  
MCC Cable  
Cable Ties & Acc  
Tooling & Cable Prep  
Fixing & Security



• Cap



• Cone



• Seal



• Body



• Nitrile O-Ring



• Locknut (Included)

### ArmaKit Dome IP68 Glands Metric

• Brass IP68 cable glands suitable for indoor & outdoor use.

**Standards:** EN 50262

**Protection:** IP68 3-5 bar

**Temperature Range:** -40°C to 100°C (static) (120° Instantaneous)

**Material (Gland):** Nickel-Plated Brass

**Material (Seal):** NBR Seal and EPDM O-Ring

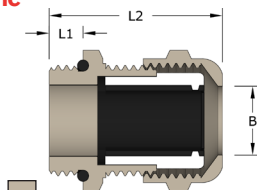

Code	Cable Range (B)		Entry Thread Size	Gland		A/F
	Min	Max		Length (L1)	Length (L2)	
DOME-NP-M12	2.0	5.0	M12 x 1.5	6.5	23.5	14
DOME-NP-M16	5.0	10.0	M16 x 1.5	6.0	25.0	20 / 18
DOME-NP-M20	6.0	12.0	M20 x 1.5	8.0	29.0	22
DOME-NP-M20L	10.0	14.0	M20 x 1.5	8.0	30.0	24 / 22
DOME-NP-M25	13.0	18.0	M25 x 1.5	9.0	36.0	30 / 27
DOME-NP-M32	18.0	25.0	M32 x 1.5	10.0	41.0	40 / 35
DOME-NP-M40	22.0	30.0	M40 x 1.5	11.0	46.0	45
DOME-NP-M50	32.0	38.0	M50 x 1.5	13.0	50.0	57 / 55
DOME-NP-M63	37.0	44.0	M63 x 1.5	14.0	52.0	64 / 68

### ArmaKit Dome IP68 Glands Metric - Long Thread

• Brass IP68 cable glands suitable for indoor & outdoor use.

• Long Thread range of brass cable glands.

**Standards:** EN 50262

**Protection:** IP68 3-5 bar

**Temperature Range:** -40°C to 100°C (static) (120° Instantaneous)

**Material (Gland):** Nickel-Plated Brass

**Material (Seal):** NBR Seal and EPDM O-Ring

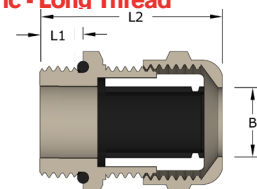

Code	Cable Range (B)		Entry Thread Size	Gland		A/F
	Min	Max		Length (L1)	Length (L2)	
DOME-NP-M12-L	2.0	5.0	M12 x 1.5	10.0	27.0	14
DOME-NP-M16-L	5.0	10.0	M16 x 1.5	12.0	33.0	20 / 18
DOME-NP-M20-L	6.0	12.0	M20 x 1.5	12.0	34.0	22
DOME-NP-M20L-L	10.0	14.0	M20 x 1.5	12.0	35.0	24 / 22
DOME-NP-M25-L	13.0	18.0	M25 x 1.5	12.0	39.0	30 / 27
DOME-NP-M32-L	18.0	25.0	M32 x 1.5	12.0	41.0	40 / 35
DOME-NP-M40-L	22.0	30.0	M40 x 1.5	15.0	46.0	45
DOME-NP-M50-L	32.0	38.0	M50 x 1.5	15.0	52.0	57 / 55
DOME-NP-M63-L	37.0	44.0	M63 x 1.5	18.0	56.0	64 / 68

