

METALLIC CABLE CLEATS

Single Fixing

Aluminium Two-Part Single-Fixing

LM6 Aluminium

The One Hole Cable Clamps are designed to fix cables 10mm to 70mm diameter. Manufactured from LM6 aluminium to BS1490. They are fully stackable and specifically designed to mount directly to channel, ladder or any flat surface.

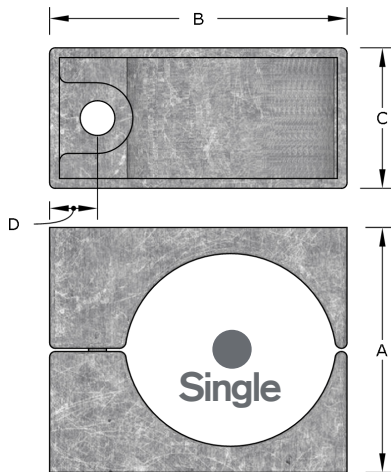

Single Fixing - Aluminium

- Fastening/fitting/routing single and multiple conductor low, medium and high voltage cables
- Excellent weathering and corrosion resistance
- Excellent stiffness
- Excellent tensile strength
- Fully recyclable

Standards: European Standard IEC 61914:2021

Temperature Range: -60°C to 100°C

Material: Aluminium LM6 (BS 1490)



Aluminium Code	Cable Range		Stud Hole Size	Dimensions				Fixing Kit
	Min	Max		(A)	(B)	(C)	(D)	
1ALM1	10.0	13.0	M10	28.0	42.0	43.0	17.0	SBFK10-100
1ALM2	13.0	16.0	M10	30.0	44.0	43.0	17.0	SBFK10-100
1ALM3	16.0	19.0	M10	32.0	48.0	43.0	17.0	SBFK10-100
1ALM4	19.0	22.0	M10	34.0	50.0	43.0	17.0	SBFK10-100
1ALM5	22.0	25.0	M10	36.0	53.0	43.0	17.0	SBFK10-100
1ALM6	25.0	32.0	M10	39.0	59.0	43.0	17.0	SBFK10-100
1ALM7	32.0	38.0	M10	44.0	65.0	43.0	17.0	SBFK10-100
1ALM8	38.0	44.0	M10	50.0	71.0	43.0	14.0	SBFK10-100
1ALM9	44.0	51.0	M10	57.0	78.0	43.0	14.0	SBFK10-125
1ALM10	51.0	57.0	M10	68.0	84.0	43.0	14.0	SBFK10-125
1ALM11	57.0	64.0	M10	75.0	91.0	43.0	14.0	SBFK10-125
1ALM12	64.0	70.0	M10	81.0	97.0	43.0	14.0	SBFK10-125



Fixing Kit (see p.206)