

# IP66 Enclosures

## Membrane Junction Box

M20 and M25 Entries Fitted with flexible waterproof membrane... Just push your cable through! Each entry is also threaded to accept an M20 cable gland. Premium quality UV Proof, Shatter Proof, and Fire Resistant construction means it's suitable for indoor and outdoor installation under driving rain and harsh sunlight. Quick-release locking screws make for quick and easy installation and inspection. 100% Corrosion Proof. Supplied with mounting plate.

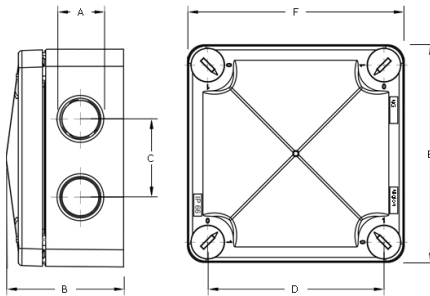

### IP66 Waterproof Junction Box

- Offers IP66 Protection
- Integrated gasket seal
- Easy installation using supplied mounting bracket
- JB86-50 = 8x M20 membrane threaded cable entries
- JB96-60 = 5x M20 + 1x M25 membrane threaded cable entries

**Protection:** IP66

**Temperature Range:** -30°C to +100°C

**Glow Wire Test:** 750°C

**Voltage:** 400V

**Enclosure Material:** PP+GF

**Gasket Material:** TPE

**Standards:** CE / Rohs / UV V0



Code	(A)	(B)	(C)	(D)	(E)	(F)	Pack QTY
JB86-50B	8x M20	50	31	70	86	86	5
JB96-60B	5x M20 + 1x M25	60	31	70	96	96	5

### Earthing Plate for JB86-50B



Code	Description	Pack QTY
SGP-8650	JB86-50 Single Earthing Plate	2
DGP-8650	JB86-50 Double Earthing Plate	2