

HAZARDOUS AREA CCG™ CABLE GLANDS | Cable Glands

INDOOR/OUTDOOR - UNARMoured

CCG FLP Hose Cable Gland

The FLP Hose Compression Gland is designed for use with unarmoured elastomeric and plastic cables where a flame-proof seal is required. The male spigot allows a protective hose to be secured at the back of the gland.

- For Group I underground mines, Group II, III, Zone 1, 2, 21, and 22 hazardous areas.
- Fitted complete with a specially formulated elastomeric captive seal for Built-in Safety™.
- A hose tail provides for clamping a protective hose over the cable.
- Two-part handling, no loose parts.
- Manufactured from high-quality brass (Marine Grade Electroless Nickel Plated™).
- Supplied complete with IP sealing washer.

Equipment Protection Levels:

IECEX/INMETRO: Ex db I Mb / Ex eb I Mb / Ex db IIC Gb / Ex eb IIC Gb / Ex nR IIC Gc / Ex ta IIIC Da
ATEX/UKEX: Ⓜ I M2, Ⓜ II 2/3G 1D, Ex db I Mb / Ex eb I Mb / Ex db IIC Gb / Ex eb IIC Gb, Ex nR IIC Gc, Ex ta IIIC Da

Conformance: Standard:

IEC/BS EN IEC/BS EN 62444
IECEX IEC 60079 Part 0, 1, 7, 15, 31
ATEX EN 60079 Part 0, 1, 7, 31
EN 60079 Part 0, 15
UKEX BS EN 60079 Part 0, 1, 7, 31
BS EN 60079 Part 0, 15

Certification:

CML 14CA364
IECEX TSA 22.0011X
CML 16ATEX1001X
CML 16ATEX4002X
CML 21UKEX1011X
CML 21UKEX4006X
DTS-01

Deluge Protection:

Marine: ABS IEC/EN 60079 Part 0, 1, 7, 15, 31 and IEC 60529
DNV IEC/EN 60079 Part 0, 1, 7, 15, 31 and IEC 60529



Protection: IP66 / IP68 Parallel IEC 60529

Temperature Range: Standard -60°C to 95°C / Extreme -60°C to 160°C

Material (Gland): Brass / Marine Grade Electroless Nickel Plated™

Material (Seal): Standard Thermoset Elastomer or Extreme Temperature Seals

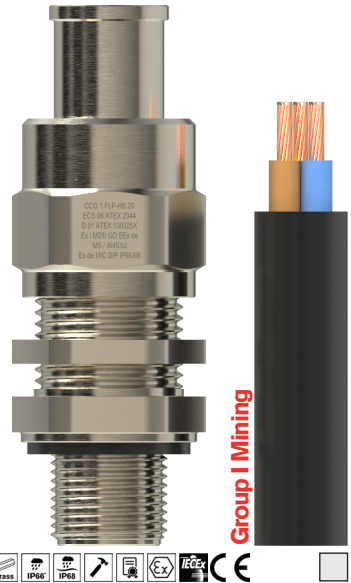

Code	Reference	Bedding OD (A)		Hose Cable OD (B)		Gland	Thread			A/F	A/C
	Size	Min	Max	Min	Max	Length (L2)	Entry (C)	Length (L1)			
052716A	00 - 16ss	3.0	8.0	15.0	-	61.0	M16 x 1.5	15.0	25.0	28.0	
052700A	00 - 20ss	3.0	8.0	15.0	-	61.0	M20 x 1.5	15.0	25.0	28.0	
0527-0A	0 - 20s	8.0	11.5	15.0	½	61.0	M20 x 1.5	15.0	25.0	28.0	
052701A	1 - 20	11.0	14.5	17.5	¾	63.0	M20 x 1.5	15.0	27.0	30.0	
052702A	2 - 25	14.0	20.2	25.9	1.0	75.0	M25 x 1.5	15.0	40.0	45.0	
052703A	3 - 32	20.0	26.5	32.2	1¼	91.0	M32 x 1.5	15.0	45.0	51.0	
052704A	4 - 40	26.5	32.5	39.2	1½	99.0	M40 x 1.5	15.0	55.0	62.0	
052755A	5s - 50s	34.0	38.0	45.0	1¾	105.0	M50 x 1.5	15.0	70.0	79.0	
052705A	5 - 50	38.0	44.5	51.0	2.0	105.0	M50 x 1.5	15.0	70.0	79.0	
052765A	6s - 63s	44.5	50.0	63.0	2¼	111.0	M63 x 1.5	15.0	85.0	96.0	
052706A	6 - 63	50.0	56.0	63.0	2½	111.0	M63 x 1.5	15.0	85.0	96.0	
052707A	7 - 75	56.0	65.0	76.2	3.0	120.0	M75 x 1.5	15.0	96.0	108.0	

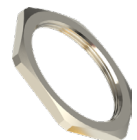
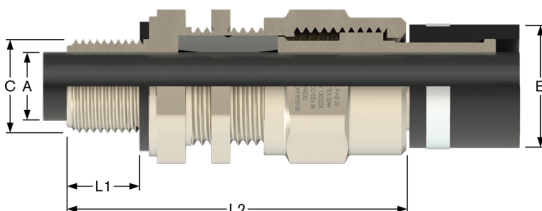

Locknuts Supplied Separately p.177

Call the Remora sales team at **01226 352 000**

Challenge us - We find a solution

Ident & Wiring Term
Copper Lugs
Heatshrink Repair
Cable Joining
Junction Boxes
Flexible Conduit
Cable Glands
Gland Accs.
Cable Cleats
Earthing Lightning
MCC Cable
Cable Ties & Acc
Tooling & Cable Prep
Fixing & Security